

# ESC 120-12

# AGM-VRLA 12V - 120Ah

## INTRODUCTION

The ESC Series is the most popular series of Rocket batteries and has a proven performance track record of more than 52 years. It has successfully exemplified its quality and reliability in some of the most demanding power conditions by providing relentless backup power supply.

## TECHNICAL FEATURES

- Non-Spillable Sealed Construction
- Absorptive Glass Mat System (AGM System)
- ABS (Acrylonitrile Butadiene Styrene) container and cover
- Gas Recombination
- Maintenance-Free Operation
- Low Pressure Venting System
- Heavy - Duty Grids
- Low Self-Discharge - Long Shelf Life
- Wide Operating Temperature Range

## APPLICATIONS

- UPS
- Telecom Communication Equipments
- Fire Alarm & Security Systems
- Medical Instruments

## COMPLIANCE STANDARDS

- IEC 60896 PART 1 & 2
- BS6290-4,
- Eurobat Guide - HIGH Performance

## CONSTANT CURRENT DISCHARGE CHARACTERISTICS UNIT: (Amperes) at 25°C

F.V/Time	5Min	10Min	15Min	30Min	1HR	3HR	5HR	10HR	20HR
1.60V	348	234	183	117	66	27	18	11	6
1.70V	303	222	176	113	63	27	18	11	6
1.75V	275	214	171	109	63	27	17	11	6
1.80V	257	209	167	107	60	26	17	10	5

## CONSTANT POWER DISCHARGE: (Watts per cell) at 25°C

F.V/Time	5Min	10Min	15Min	30Min	1HR	3HR	5HR	10HR	20HR
1.60V	580	421	336	219	125	54	35	22	11
1.70V	523	400	322	211	120	53	35	21	11
1.75V	494	390	318	207	119	52	34	21	11
1.80V	462	376	306	200	114	52	34	21	11

## SPECIFICATIONS

Nominal Voltage		12V
Dimensions	Length	406mm
	Width	173mm
	Height	218mm
	Total Height	218mm
Approx Weight		35.6kg
Design Life		10 Years

## CHARACTERISTICS

Capacity		120Ah
Internal Resistance (Fully Charge , 25°C)		Approx.3.8mΩ
Self Discharge (27°C)	1 month	Remaining Capacity: 97%
Operating Temperature Range		-15°C ~ 40°C
Maximum Discharge current		1000A (5sec)
Maximum Charging current		33A
Charge Methods (Constant Voltage Charge 80.6°F (27°C) - Cyclic Use		Cycle Use 14.2 to 14.9V Temp. Compensation - 30mV/°C
Charge Methods (Constant Voltage Charge 80.6°F (27°C) - Standby Use		Standby Use 13.5 to 13.8V Temp. Compensation - 20mV/°C

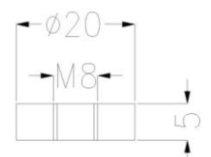
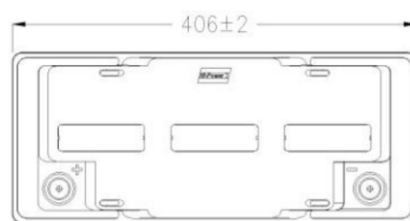
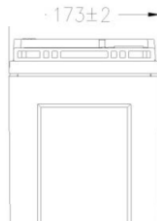
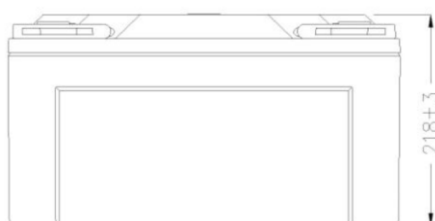

TERMINAL

www.rocketbatt.com